

# MR. CRAPPIE® Slab Shaker™

## Crappie Reels SDI

*MCRD1*

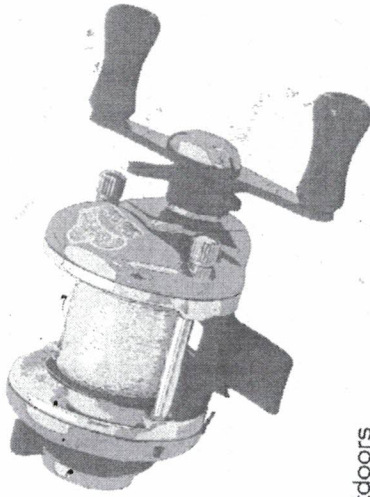

Do Outdoors  
 2253 E. Bennett St. Springfield, MO 65804  
 417-881-5397 www.mrcrappie.com

fig 1 To remove side cover unscrew side-plate screws pry front cover away from body to access components

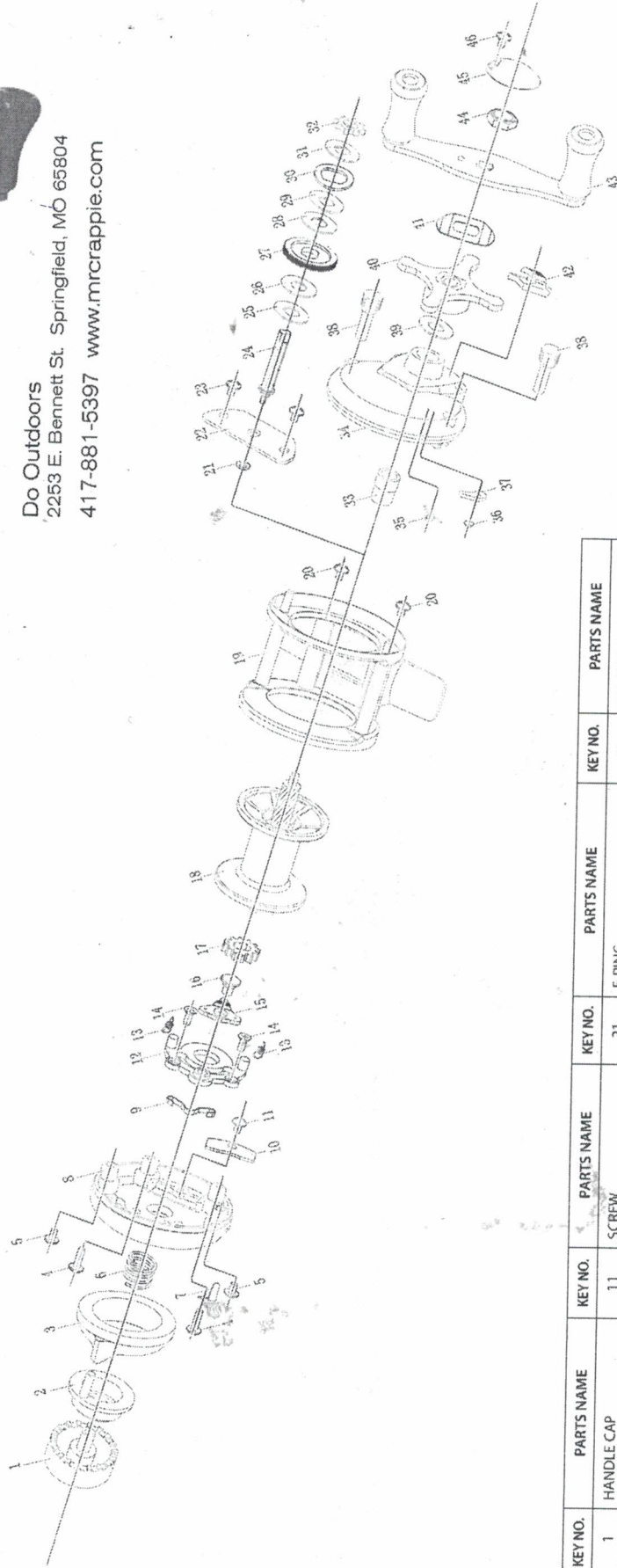

KEY NO.	PARTS NAME	KEY NO.	PARTS NAME	KEY NO.	PARTS NAME	KEY NO.	PARTS NAME
1	HANDLE CAP	11	SCREW	21	E-RING	31	WASHER A
2	LOCALIZATION PLATE	12	FRAME	22	TIE-STRUT	32	RACLET WHEEL BACKSTOP
3	DRIVE PLATE	13	SPRING	23	SCREW	33	BAIL BEARING
4	SCREW	14	SCREW	24	GEAR SHIFT	34	RIGHT COVER
5	SCREW	15	PAWL PLATE	25	WASHER A	35	SPRING
6	SPRING	16	PAWL PIN	26	FRICTION WASHER	36	E-RING
7	CLIP	17	PAWL	27	DRIVE GEAR	37	RETAINER PLATE
8	LEFT COVER	18	SPOOL	28	FRICTION WASHER	38	NUT A
9	PAWL SLICE	19	FRAME	29	WASHER A	39	WASHER A
10	PLATE	20	SCREW	30	DRAG SPRING WASHER	40	STAR DRAG
						41	WASHER
						42	ANTI-REVERSE SHAFT
						43	HANDLE
						44	NUT B
						45	NUT B CAP
						46	SCREW

*SDI-RH-UA*