



**SPEED CAST®**

**SC600**



**6-PIN CBS**  
Central Brake System

*Lew's is driven by innovation –  
Fueled with Passion*

**Feel the Difference!**

### Reel Specifications

Model	Weight (oz.)	Gear Ratio	Line Capacity (yd./lb.)	RPT*
SC600	11.8	5.3:1	300/15	23"

\*Recovery per turn.

### FEATURES:

- Aluminum frame and sideplates
- Premium 5-bearing system with 4-ball bearings and Zero Reverse one-way clutch bearing
- Anodized aluminum spool
- 6 pin Central Brake System (CBS)
- Carbon fiber drag
- 100mm power handle with oversize EVA grip

### ATTENTION BRAIDED LINE USERS!

If your Lew's® Baitcast reel has pre-drilled holes in the spool, you may tie your braid directly to the spool, by passing the braid thru the provided holes and tying a uni-knot.

If your Lew's® baitcast reel does not have pre-drilled holes in the spool, you will need to first tie on and spool at least 20 revolutions of monofilament line, and then tie your braided line to the monofilament line, with either a back-to-back uni-knot or an Albright knot.

Continue to spool your reel as normal, keeping strong tension on the line to ensure the line is firmly wound onto the spool to keep from "digging in" to underlying line layers when pressure is put on the line from fighting fish.

**FAILURE TO PROPERLY SPOOL BRAIDED LINE ONTO YOUR REELS SPOOL WILL RESULT IN LINE SLIPPAGE, AND THE IMPRESSION YOUR DRAG IS NOT WORKING PROPERLY.**

### Maintenance and Care

While applying lubricant to your Lew's® Speed Cast® reel, avoid using multi-purpose oil. Use lightweight silicone based oils or greases made for fishing reels. Apply oil to all bearings and the main shaft. Apply grease to the bushings, pinion gears and main gears.

After usage your reel should be inspected for dirt or sand and cleaned if excessive buildup is present. If your reel has come in contact with saltwater it is important to flush all parts with water, dry and re-lubricate your reel. Through diligent cleaning and maintenance your Lew's® reel will provide you with years of reliability and sound performance.

### One Year Limited Warranty

#### For Warranty information and registration go to lews.com

Lew's® Warrants its products<sup>1</sup> to withstand normal<sup>2</sup> use for the purpose designed and intended when manufactured for a period of one (1) year from the original retail sale date to the original retail consumer. Lew's® will at its option repair or replace<sup>3</sup> Lew's® products when required for the warranty period and return<sup>4</sup> the product to the owner at no additional<sup>5</sup> cost to the owner.

<sup>1</sup>Numerous products have been manufactured under variations of the Lew's® name and under the Lew's® Logo by multiple businesses over the past 50 years. This warranty is specifically for products manufactured on behalf of Lew's® of Springfield, Missouri, USA since January 1, 2010. Lew's® products manufactured by or on behalf of other entities prior to January 1, 2010 are not covered by this warranty. In all circumstances, this Warranty is Limited in Value to the original retail value of the product and is limited to actual damage to the Lew's® product and only the Lew's® product. <sup>2</sup>Loss of a product, and loss/damage of a product or parts due to the attempted repair or servicing of a Lew's® product by any person or business other than Lew's® or Lew's® Authorized Warranty Service Agent, and damage caused by or resulting from abuse, misuse, lack of recommended maintenance, accident, acts of God, and shipping damages occurring in transit to Lew's® or Lew's® Authorized Agent are outside the scope of Lew's® Limited Warranty and will be repaired through Lew's® after warranty services at the expense of the consumer. <sup>3</sup>Any products replaced by Lew's® will be new or remanufactured by a Lew's® Authorized Agent with the same or next model upgrade product. <sup>4</sup>Lew's® will return warranted products to the consumer by reasonable means as determined by Lew's®. <sup>5</sup>Express or expedited services are the responsibility of the consumer as is sending the product to Lew's® or Lew's® Authorized Agent, for Warranty Service. Lew's® and Lew's® Service Agents as authorized by Lew's® are the sole agents authorized to repair or replace Lew's® products under the terms of this warranty. Only written changes by an officer of Lew's® can alter the terms or conditions of this warranty.

This warranty gives you specific legal rights including additional rights extended by some states which do not allow certain exclusions and limitations. Any action brought against Lew's® for the purpose of settling a warranty dispute shall be brought and litigated in the State of Missouri, County of Greene.



# SPEED CAST<sup>®</sup>

## SC600

For professional cleaning and maintenance  
send your reel postage prepaid to:

LEW'S<sup>®</sup> 3080 Sawyer Road, Republic, MO 65738  
877-470-5397 or 417-522-1093

Register Lew's product  
warranty online at: [lews.com](http://lews.com)

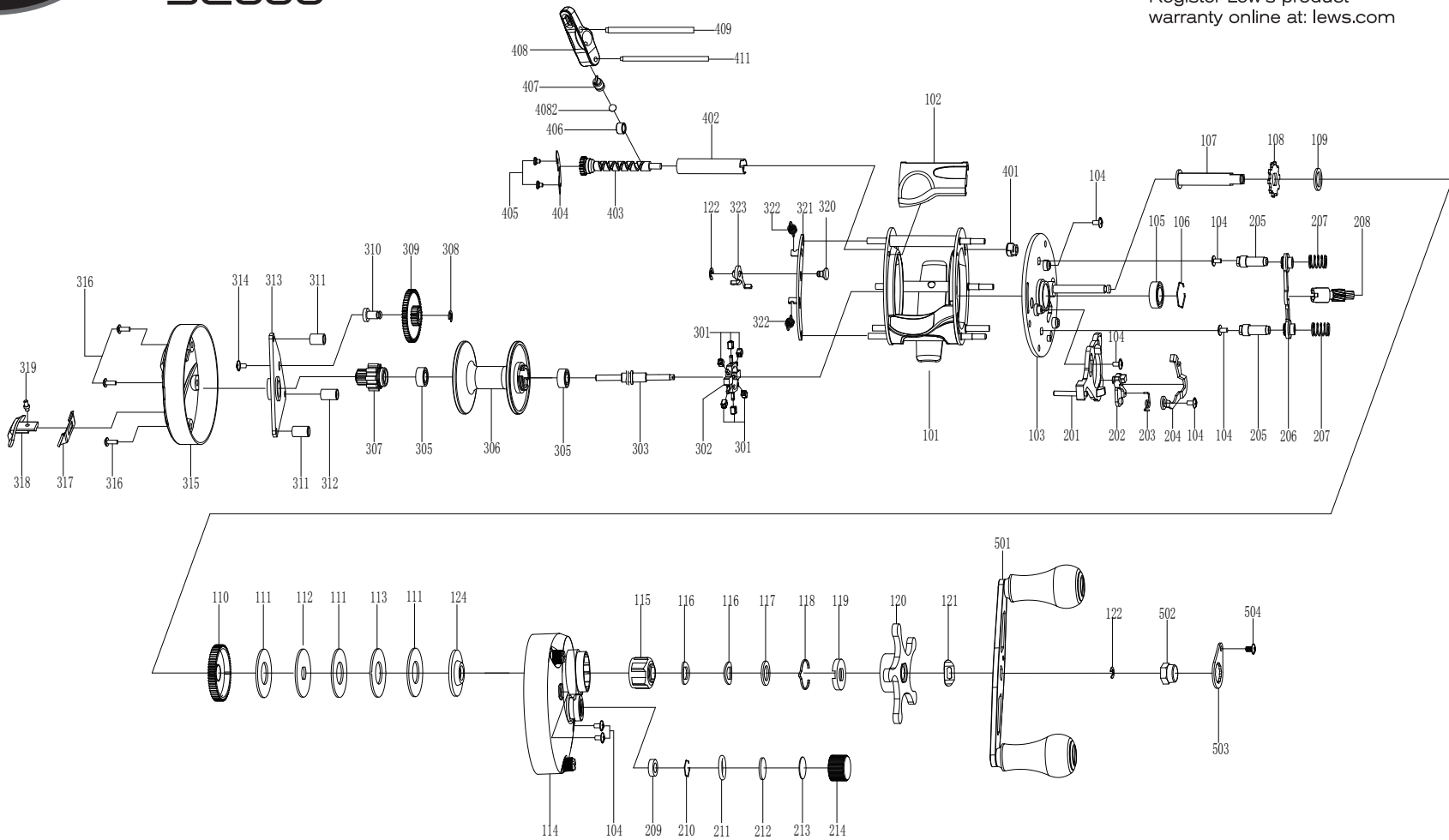

KEY NO.	PARTS NAME	KEY NO.	PARTS NAME	KEY NO.	PARTS NAME	KEY NO.	PARTS NAME	KEY NO.	PARTS NAME	KEY NO.	PARTS NAME	KEY NO.	PARTS NAME
101	Frame	113	Eared washer	202	Kick Lever	214	Cast control cap	313	Inner support frame	402	Level Wind Guard	501	Handle Assembly
102	Thumb rest plate	124	Bowl-shape washer	203	Clutch spring	201	Drag bushing	314	Screw	403	Worm Shaft	502	Handle Nut
103	Retaining plate	114	Right cover	204	Yoke gear plate	302	Friction support	315	Left cover	404	Line gear holding plate	503	handle nut plate
104	Screw	115	Roller clutch	205	Yoke pin	303	Spool shaft	316	Screw	405	Screw	504	Screw
105	Ball bearing	116	Drag spring washer	206	Yoke	305	Ball bearing	317	Spring	406	Line guide bushing		
106	Spring	117	Washer	207	Spring	306	Spool assembly	318	Pawl wheel switch	407	Line Guide Pawl		
107	Drive shaft	118	Click Spring	208	Pinion gear	307	Pawl	319	Positioning pin	408	Line guide holder		
108	Anti-reverse ratchet	119	Clicker frame	209	Ball bearing	308	E-lock	320	Positioning pin	4082	Washer		
109	Washer	120	Star drag	210	Spring	309	Worm shaft gear B	321	Pawl guide plate	409	Stabilizer Bar		
110	Drive gear	121	Convex washer	211	O-ring	310	Fix shaft	322	Spring	411	Stabilizer Bar		
111	Washer	122	E-lock	212	Washer	311	Fix shaft	323	Click Pawl				
112	Washer	201	Clutch Cam	213	Washer	312	Fix shaft	401	Worm shaft right bushing				